

COUNTRY COLLECTIBLES PRESENTS #45

DISTINCTIVE

**COLOR & MATERIALS
THAT WORK TOGETHER**

Kitchen

SOLUTIONS

2008 WINNERS

**THE NEW
MUST-HAVES**

WHAT'S GOT EXPERTS BUZZING



**COOL GADGETS
YOU CAN'T
LIVE WITHOUT**

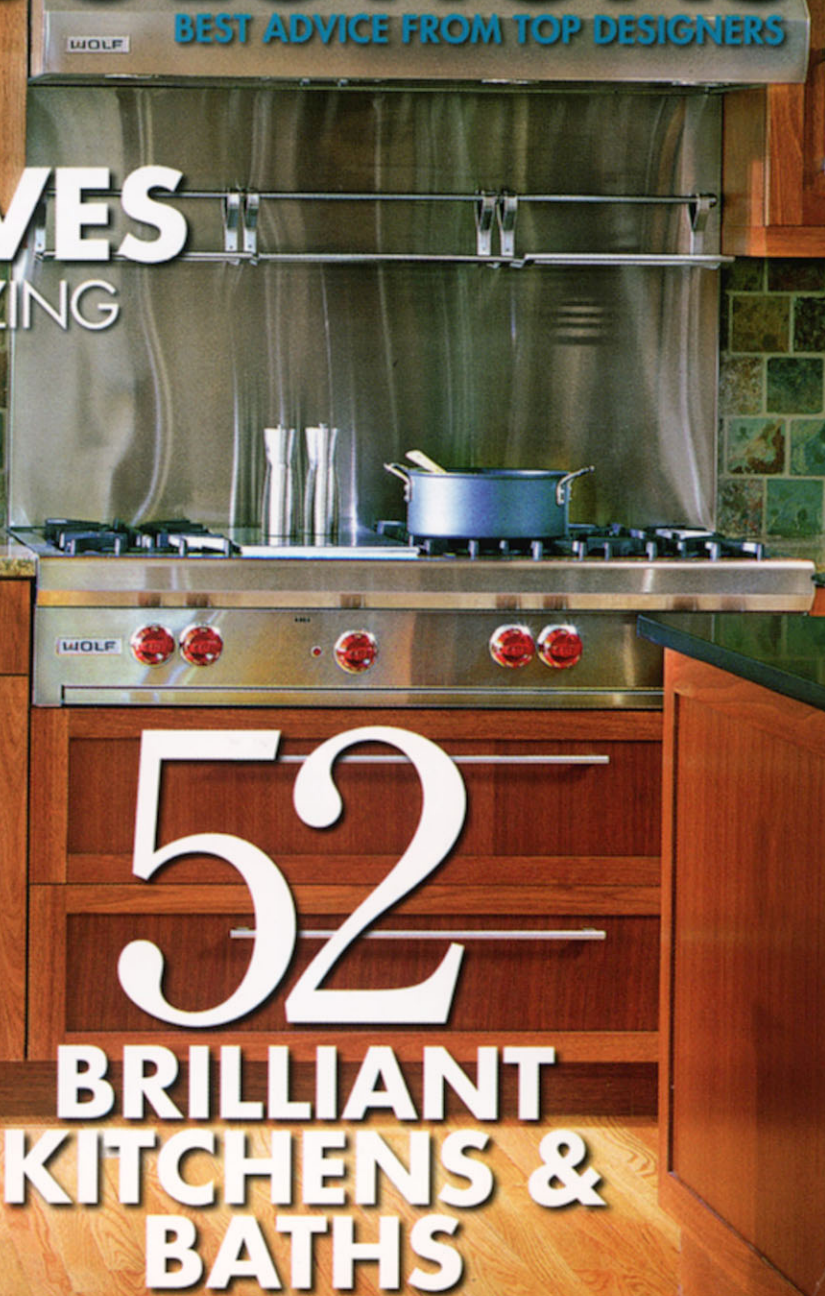

52

**BRILLIANT
KITCHENS &
BATHS**

**KEY TRENDS: INNOVATIVE STORAGE
APPLIANCES * SURFACES * GREEN OPTIONS**



PLAY UNTIL NOV. 17, 2008



Natural materials used in this bathroom, including luxurious marble, glass and rich wood, reflect the 1913 period of the house.

OPPOSITE: Heated towel bars and a European-style hand-held showerhead add hotel-like ambience.

hotel amenities

UPDATED TRADITIONAL DÉCOR

WISH LIST

- For the bathroom to resemble a hotel bathroom
- Generous lighting
- Larger shower

Because of the age of their 1913 suburban Chicago home, a couple with three children wanted their remodeled bathroom to reflect the time period when the house was built. They also wanted the bathroom to have the feel of a high-end hotel and to be a lot lighter (it was dark when they moved in) as well as much more functional. The shower was small and there was sufficient storage—but not in areas where the owners wanted it to be. Chicago

designer Leslie Markman-Stern has always relished a challenge. She is adept at not only maximizing square footage but also at incorporating traditional choices that soothe and pamper into her design scheme to create a fresh, inviting ambience. To give the bathroom a brighter, more airy feeling, she started by raising the ceiling.

To set the mood, Markman-Stern selected Statuary Veneto marble for the flooring, shower walls, tub deck and surround, and vanity countertop. She chose a maple cabinetry but stained it to a cherry finish to match cherry mirror frames, and she opted for a partial wall of glass block. The new shower design is much larger than the prior one, and a frameless shower door contributes to the overall feeling of a bright, spacious room. A separate area houses the bidet, another of the special requests of the homeowners. And more light comes from different sources: recessed cans and wall sconces as well as the glass block window.

To give the room a bit of the high-end luxury hotel touch the wife has experienced while traveling on business, Markman-Stern incorporated a towel warmer and an adjustable hand-held spray showerhead. With so much richness in materials, she felt it was important to keep to a neutral palette, with the major color and pattern coming from the white and gray marble, the glass block wall and the wooden vanity cabinets. The marble was honed for safety on the floor. Walls were painted gray, while fixtures are a crisp white.

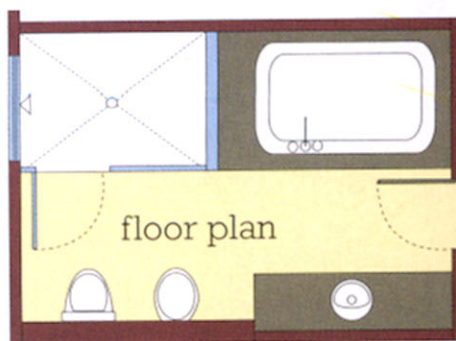

DESIGNER:

Leslie Markman-Stern
Leslie M. Stern Design
2131 N. Fremont St.
Chicago, IL 60614
773-248-2049

lesliemsterndesign.com

LOCATION: Glencoe, IL

DIMENSIONS:

8' by 11'

>>> SPECIAL FEATURES:

Bidet; Heated towel bar;
Generous-size shower

PRODUCTS USED:

- Toilet, bidet: Toto
- Tub, sink: Kohler, Bubble Massage model; Caxton sink
- Shower enclosure: S & S Glass
- Faucets: Grohe
- Marble: Statuary Veneto
- Marble fabricator: Marble by David
- Vanity, mirror frame: Fabricated by Hoffman Custom Designs; design by Leslie Markman-Stern
- Wall sconces: Murray Feiss
- Towel warmer: Artos

