

COUNTRY COLLECTIBLES PRESENTS #39

**DISTINCTIVE**

**EXPERTS SAVE YOU \$\$\$**  
THE BIGGEST VARIETY OF STYLES

# Kitchen

**SPECIAL DOUBLE ISSUE**

**SOLUTIONS**

BEST ADVICE FROM TOP DESIGNERS

# 52 BRILLIANT KITCHENS & BATHS

**INNOVATIVE  
DESIGNS FOR  
PROBLEM SPACES**

**ECO-FRIENDLY  
FEATURES YOU  
HAVE TO SEE**

SEE HOW **DIFFERENT  
PRODUCTS & MATERIALS**  
WILL AFFECT YOUR ROOMS



DISPLAY UNTIL DECEMBER 17, 2007

# kitchen

## works with a view

A NEW HOUSE BRINGS  
LAKE VISTAS INDOORS

### WISH LIST

- Open-style kitchen with enough room between zones
- Views toward the lake
- Comfortable seating to make kitchen the hub of the house

Because the wife likes to cook and wanted her kitchen in Chicago, Illinois, to be highly organized, she hired designer Leslie Markman-Stern to help plan its final look while the

design/build firm of Benvenuti and Stein, Inc. was constructing the house and custom cabinets.

"The challenge was to make it comfortable, be easy to take care of, have good storage and make it feel open," explains the designer. To give the ample space some visual punch, Markman-Stern decided to use different dyes and woods—birch dyed a silver blue for the island cabinets and maple dyed light beige on perimeter cabinets.

To add a spark of color, Markman-Stern incorporated some blue tones in small mosaic glass tiles that run through the tumbled stone backsplashes, behind the range and on its hood. A metallic accent contributes a splashier, reflective accent in the appliance fronts, cabinet pulls and hanging pendant lights.

More color comes from the island's dark blue granite top which acts as a nice complement to the creme and black with blue speckled granite used on surrounding countertops. The floor, paved in a deep Brazilian cherry, adds warmth.



PAUL SCHLISIMANN

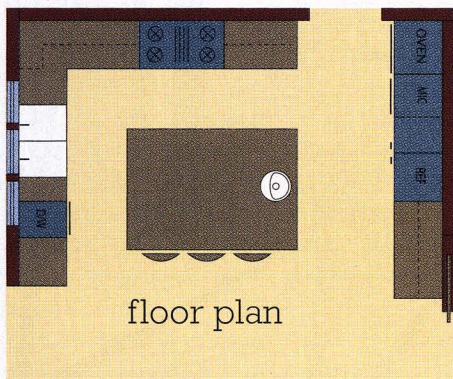



**INTERIOR DESIGNER:**

Leslie Markman-Stern,  
ASID  
Leslie M. Stern Design  
2131 N. Fremont St.  
Chicago, IL 60614  
773-248-2049  
www.lesliemsterndesign.com

**DESIGN/BUILD FIRM:**

Benvenuti and Stein, Inc.  
2001 Greenleaf St.  
Evanston, IL 60202  
847-866-6868  
www.benvenutiandstein.com

**>>> SPECIAL FEATURES:**

Big windows and glass doors to give lake views; Glass-tiled gas fireplace; Mix of cabinetry materials for visual interest

**LOCATION:** Chicago, IL

**DIMENSIONS:**

30' by 17'

**PRODUCTS USED:**

- Refrigerator/freezer and refrigerator drawers: Sub-Zero
- Ovens: Thermador
- Cooktop: Viking
- Dishwasher: Miele
- Sinks: Franke
- Hood: Best by Broan, in custom cabinet
- Disposal: KitchenAid
- Cabinets: Custom, by Benvenuti and Stein, Inc.

Both the main and prep sinks were oriented toward the windows and lake views, a prime reason the owners selected the site for their new home.